

■ PREMIER COLLECTION

The Classic

Available: Power, Manual, Power XL, Manual XL



The Classic is an economical recliner which has a rock-solid steel frame and heavy-duty casters, making it ideal for a variety of applications and environments.

Regardless of size, location, and type — every medical facility needs seating solutions that meet the needs of their patients and providers.

The Classic provides patient comfort and ease of use, plus product longevity and dependability.



Key Benefits

- This workhorse recliner is perfect for facilities of any size and budget, and it's engineered to meet the most demanding applications.
- Infinite recline positions and either stationary or swing-away arms provide optimal patient comfort and better access for caregivers.
- With fold-away tables, foot trays and quick-release seats, caregivers get more versatility and convenience from a medical recliner.
- For quality engineering and patient-centric innovation that prioritizes functionality, safety, and comfort, Champion products comply with ISO 13485 and are made in the USA.

Common Applications:

Dialysis Settings

Standard Features



Trendelenburg Positioning



Swing-Away Arms



Foot Tray



5" (12.7 cm)
Casters



Fold-Down Side Table

(Additional standard features are also included. Talk to a Sales Rep for details.)

Space Requirements

Front View

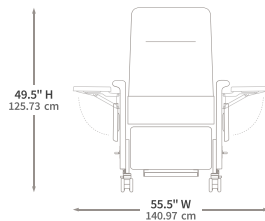

Top View

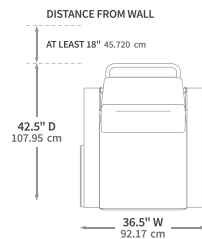

Side View

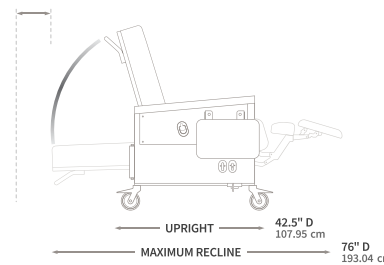

Top View with Swing Away Arms

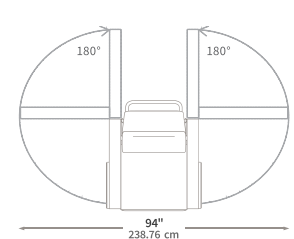

Model 85 shown with optional second fold-away table.

Specifications

	Standard	XL
Power Recline	Yes, Model: 85P	Yes, Model: 86P
Manual Recline	Yes, Model: 858	Yes, Model: 868
Weight Capacity	300 lbs. / 136 kg	500 lbs. / 226 kg
Back Height (from floor ♦ from seat)	48.50" ♦ 28.50" 123.19 cm ♦ 72.39 cm	49.50" ♦ 29.50" 125.73 cm ♦ 74.93 cm
Overall Width (with 2 gray tables down ♦ up)*	32.75" ♦ 51.75" 83.19 cm ♦ 131.44 cm	36.50" ♦ 55.50" 92.17 cm ♦ 140.97 cm
Maximum Width (arms open at widest)	90" / 228.60 cm	94" / 238.76 cm
Minimum Width (arms open at 180°)	32.75" / 83.19 cm	36.50" / 92.71 cm
Seat Width	22.75" / 57.79 cm	26.75" / 67.95 cm
Seat Height ♦ Seat Depth	25.50" ♦ 19.50" 64.77 cm ♦ 49.53 cm	25.50" ♦ 19.50" 64.77 cm ♦ 49.53 cm
Arm height (highest point from floor)	29.75" / 75.57 cm	29.75" / 75.57 cm
Overall Upright Depth (with handle) ♦ Trendelenburg Depth	42.50" ♦ 75" 107.95 cm ♦ 190.50 cm	42.50" ♦ 76" 107.95 cm ♦ 193.04 cm
Thermoplastic Casters (diameter)	5" / 12.70 cm	5" / 12.70 cm

Available Options



Heat + Massage
Tabletop Switch



USB Charging
Port



TV/Monitor
Mount



Paper Roll
Dispenser



IV Pole
Options

(Additional available options are also offered. Talk to a Sales Rep for details.)