

■ PREMIER COLLECTION

Alō Recovery

Available: Power, Manual, Power XL, Manual XL



With the same bells and whistles as the Alō Treatment recliner, our flagship chair for treatment in oncology and infusion settings, the Alō Recovery has a lower working height for patients and caregivers alike, with use across a variety of acute applications and environments. Infinite recline positions with swing-away arms provide optimal patient comfort and better access for providers. These medical recliners are available in a range of fabrics and finishes.



Key Benefits

- Modular in design for adaptable configurations in any facility, and every chair boasts an all-steel base and frame for the most demanding use.
- With fold-away tables, foot trays and quick-release seats, caregivers get more versatility and convenience from a Champion recliner.
- Infinite recline positions with swing-away arms provide optimal patient comfort and better access for caregivers.
- For quality engineering and patient-centric innovation that prioritizes functionality, safety, and comfort, Champion products are subject to the ISO and made in the USA.

Common Applications:

Oncology & Infusion Settings

Standard Features



Trendelenburg Positioning



Swing-Away Arms



Foot Tray



Fold-Down Side Table



Push Handle

(Additional standard features are also included. Talk to a Sales Rep for details.)

Space Requirements

Front View

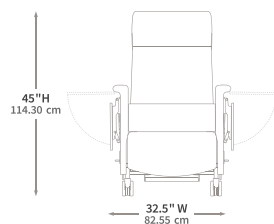

Top View

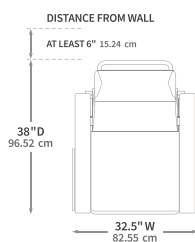

Side View

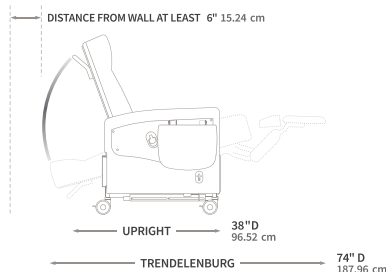

Top View with Swing Away Arms

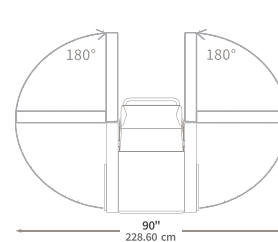

Shown with optional second, fold away table.

Specifications

| | Straight Back | Wing Back | XL Straight Back | XL Wing Back |
|--|--|--|---|--|
| Powered Recline | Yes, Model: 61PL | Yes, Model: 63PL | Yes, Model: 62PL | Yes, Model: 64PL |
| Manual Recline | Yes, Model: 61OL | Yes, Model: 63OL | Yes, Model: 62OL | Yes, Model: 64OL |
| Weight Capacity | 300 lbs. / 136 kg | 300 lbs. / 136 kg | 500 lbs. / 226 kg | 500 lbs. / 226 kg |
| Back Height (from floor ♦ from seat) | 45" ♦ 26.75" 114.30 cm ♦ 67.94 cm | 48.50" ♦ 31" 123.19 cm ♦ 78.74 cm | 45.50" ♦ 27.25" 115.60 cm ♦ 69.21 cm | 49" ♦ 31" 124.50 cm ♦ 78.74 cm |
| Overall Width (arms closed) | 32.50" / 82.60 cm | 32.50" / 82.60 cm | 36.50" / 92.71 cm | 36.50" / 92.71 cm |
| Seat Width | 23" / 58.42 cm | 23" / 58.42 cm | 27" / 68.60 cm | 27" / 68.60 cm |
| Seat Height ♦ Seat Depth | 19.88" ♦ 20.50" 50.48 cm ♦ 52.10 cm | 19.88" ♦ 20.50" 50.48 cm ♦ 52.10 cm | 19.88" ♦ 20.50" 50.48 cm ♦ 52.10 cm | 19.88" ♦ 20.50" 50.48 cm ♦ 52.10 cm |
| Arm Height (highest point from floor) | 29" / 73.70 cm | 29" / 73.70 cm | 29" / 73.70 cm | 29" / 73.70 cm |
| Overall Upright Depth (with handle) | 38" / 96.52 cm | 38" / 96.52 cm | 43" / 109.22 cm | 44" / 111.80 cm |
| Trendelenburg Depth | 74" / 187.96 cm | 78" / 198.12 cm | 74" / 187.96 cm | 78" / 198.12 cm |
| Dual Thermoplastic Casters (diameter) | 4" / 10.16 cm | 4" / 10.16 cm | 4" / 10.16 cm | 4" / 10.16 cm |

Available Options



Stylish Black Arm Caps

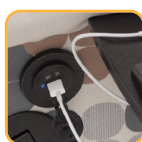

USB Charging Port

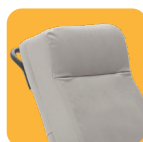

Straightback Design



Central-Locking Caster System



Heat + Massage Tabletop Switch

(Additional available options are also offered. Talk to a Sales Rep for details.)