



OWNER'S OPERATING AND MAINTENANCE MANUAL



Privacy Screens

1-800-237-3377

CHAMPIONCHAIR.COM



IMPORTANT

READ AND FAMILIARIZE YOURSELF WITH ALL INSTRUCTIONS BEFORE USING THIS PRODUCT!

Do NOT install, maintain or operate this equipment without reading and following this manual, otherwise injury and/or damage may result.

IF YOU HAVE ANY QUESTIONS OR CONCERNS, PLEASE CONTACT CHAMPION MANUFACTURING, INC .

Champion assumes no responsibility for damage or injury caused by improper assembly, installation, use, or maintenance of these products.

No part of this manual may be duplicated in any form without the prior consent of Champion Manufacturing, Inc . Unauthorized duplication/distribution of these materials may result in civil prosecution to the maximum extent allowed by law.

The information contained in this manual is subject to change without notice.

SAVE THESE INSTRUCTIONS FOR FUTURE REFERENCE!

These instructions are available online at no charge.
Visit ChampionChair.com to download.

TABLE OF CONTENTS

Important Safety Information 4

Transportation, Storage, Handling & Disposal 5

Tools Needed 5

3130 Three Panel Screen..... 6

 Prepare Leg Assemblies..... 6

 Leg Installation 6

3170 Privacy Screen 8

 Leg Installation 8

 Panel Replacement 8

GENERAL CARE & CLEANING 10

Specifications..... 11



WARNING IMPORTANT: PLEASE READ

READ AND FOLLOW ALL DIRECTIONS.

1. **NEVER** place screen on a cart, table, stand or other objects; Screen could fall and **SERIOUS INJURY MAY OCCUR.**
2. **NEVER** place screen near open flame or over a radiator or heat register.
3. **NEVER** place screen in front of a door; In case of emergency screen could block or hinder evacuation.
4. **SUFFOCATION DANGER** to children if vinyl is not attached to screen; Screen could block nose and mouth and prevent breathing. **VINYL SCREEN IS NOT A TOY.**
5. **DO NOT** allow children to play with screen; Screen could fall and **SERIOUS INJURY MAY OCCUR.**
6. Periodically, recheck tightness of all nuts, bolts and screws.
7. Screen should **ALWAYS** be positioned on level surface.
8. **NEVER** stand or ride on screen legs; **SERIOUS INJURY MAY OCCUR.**
9. **DO NOT** use screen in or with **ANY** type of vehicle or trailer.
10. **DO NOT** attach objects to screen frame; Screen can tip over and **SERIOUS INJURY MAY OCCUR.**
11. Immediately remove from service; Any screen with broken or missing parts, torn vinyl, or other visible damage.
12. **USE ONLY CHAMPION AUTHORIZED REPLACEMENT PARTS.**
13. **SAVE THESE INSTRUCTIONS** for future reference and training.

MAGNET DISCLAIMER

The 3170 model screen contains neodymium magnets – It is required that the buyer read and understand the instructions before using this product.



WARNING

Magnets can pose dangers to children and adults. Magnets should never be swallowed or inserted into any body part. Mishandling of magnets may cause injury or property damages. Keep magnets away from people using pacemakers or other medical devices. Also, keep magnets away from CRT monitors, CRT TVs, and other electronic devices.

TRANSPORTATION, STORAGE, HANDLING & DISPOSAL

- The product should be transported in factory packaging, inside an appropriate medium for the destination, i.e., air/sea cargo containers.
- The product should be stored in an environment that will inhibit rust/mold formation.
- Champion Manufacturing, Inc recommends not leaving the product in the factory packing in excess of three (3) months.
- The product should always be handled in a manner consistent with the user instructions and in a manner to prevent contamination after each use.
- The product has many recyclable components and to the extent practical, all effort should be used to recycle responsibly. Otherwise the product components shall be disposed of in accordance with local statutes.

TOOLS REQUIRED

3130 THREE PANEL SCREEN

- Phillips-Head Screwdriver
- $\frac{7}{16}$ " wrench, adjustable wrench, or $\frac{7}{16}$ " socket & ratchet wrench
- Scissors or box cutter
- If using powered tools always start hardware together by hand first

3170 PRIVACY SCREEN

- Scissors or Box Cutter
- $\frac{5}{32}$ Allen Wrench (provided)
- Phillips Screwdriver

PLEASE READ AND FAMILIARIZE YOURSELF WITH ALL INSTRUCTIONS BEFORE PROCEEDING WITH ASSEMBLY. IF USING POWERED TOOLS ALWAYS START PUTTING HARDWARE TOGETHER BY HAND FIRST.

3130 THREE PANEL SCREEN

PREPARE LEG ASSEMBLIES

1. If not already installed, insert the caster inserts into open ends of screen legs. (This is done for crutch tip or caster installation.)
2. You must choose either casters or crutch tips for your screen – both are provided to you. Casters must be inserted into the caster inserts. Crutch tips must be installed over the ends of the legs.

LEG INSTALLATION

3. Install legs on mainframe using (4) ¼" x 1-1/2" Phillips head screws and locknuts.

NOTE: Make sure the legs are installed so that the bends of the legs face the outside of the frame. This is necessary to provide the maximum footprint.

4. Use your Phillips head screwdriver and 7/16" wrench to tighten.
5. Bolts must fit snugly into holes for secure leg mount.
6. Verify that your screen is level and straight. If necessary the legs can be slightly bent so that all legs touch the floor and screen stands straight.



Periodically recheck tightness of all fasteners and **NEVER** stand on or hang from the screen.

IMPORTANT:

PANEL REPLACEMENT

1. To replace Vinyl Panels, grasp Screen Rod; Screen Rod is spring-loaded and can be moved toward end with spring. Push & pull the Screen Rod to determine which way will compress the spring and allow removal of the Screen Rod.
2. Re-install the Screen Rod by reversing the above procedure.
3. Periodically check all fasteners for tightness. To clean Vinyl Panels use only mild liquid soap and water.
 - Wrinkles in Vinyl – Storage and shipping causes wrinkles of the vinyl of your screen; This is normal. Please allow 1 – 2 weeks at room temperature (approx. 70+ degrees) to allow for vinyl to return to original appearance.

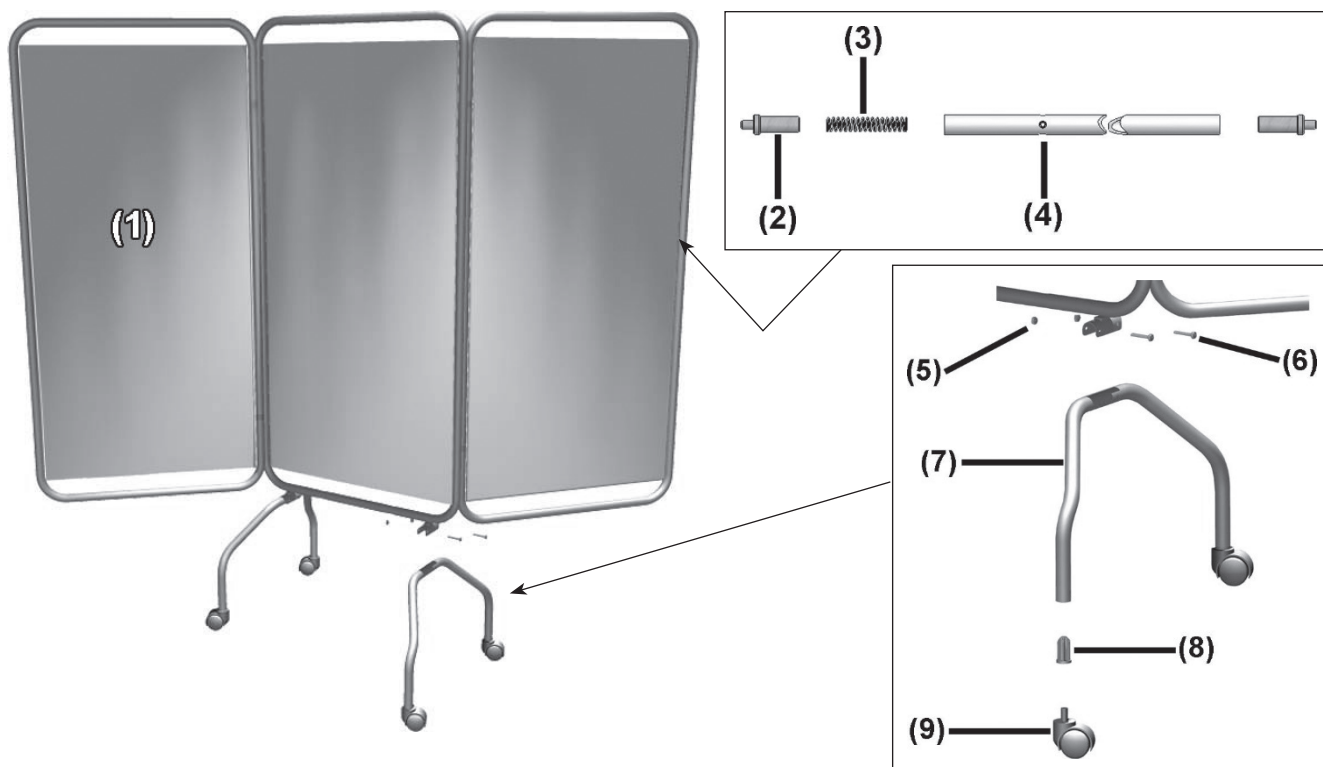

Items Included with Screen:

Item

No.	Description	Qty.
1	Vinyl Panel	3
2	Insert, Screen Rod Plastic	12
3	Rod Spring	6
4	Screen Rod	6
5	1/4-20 Lock Nut	4
6	1/4-20 x 1-1/2" Machine Screw	4
7	Double Leg	2
8	Caster Insert	4
9	Caster, 2"	4

NOT SHOWN: Crutch Tip, 1" gray w/ washer
(Available with 3130 Model Only)

3170 PRIVACY SCREEN

LEG INSTALLATION *(SEE PHOTOS ON NEXT PAGE)*

1. Using a Phillips Screwdriver, install (2) **Screen Leg Reinforcement Tubes (#5)** between **Leg Frame Assemblies (#3)** using 4-Phillips Head Screws (5A), one on each end, through **(#3)** into **(#5)**. Leave screws on one **Leg Frame Assemblies (#3)** loose to allow assembly to be inserted into **Wing/Mid Frame Assembly (#1A)**.
2. Insert both **Leg Frame Assemblies (#3)** into the bottom of the **Wing/Mid Frame Assembly (#1A)**. Line up the holes in **(#3)** w/ the holes in **(#1A)**.
3. Using the **Allen Wrench** provided, screw in **1-Button Socket Screw (3D)**, per leg, through **(#1A)** and into **(#3)**. Tighten **2-Phillips Head Screws (5A)** that were left loose in step 2.

PANEL REPLACEMENT *(SEE PHOTOS ON NEXT PAGE)*

4. To replace **Vinyl Panels (#4)**, hold the screen by the top **Screen Rod (#2A)**.
5. Next, using the **Allen Wrench** provided, push in on the small hole just below the **Snap Button (#2B)**.
6. Re-install **(#2A)** by repeating the above procedure, then release **(#2B)** when **(#2A)** is in place.

IMPORTANT:

- **Wrinkles in Vinyl – Storage and/or shipping can cause wrinkles in the vinyl screen. This is normal. Please allow 1-2 weeks at room temperature (approx. 70+ degrees) to allow for vinyl to return to original appearance.**

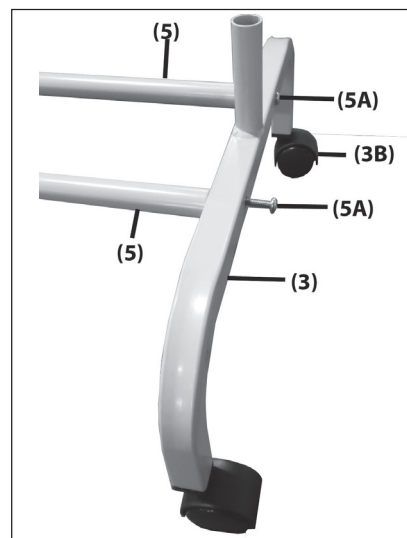
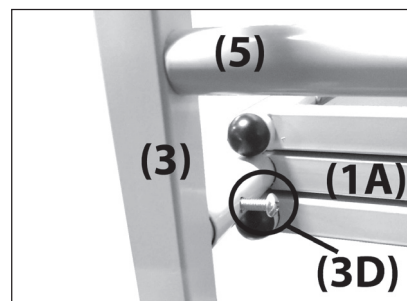
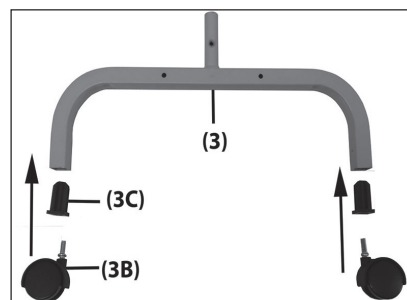
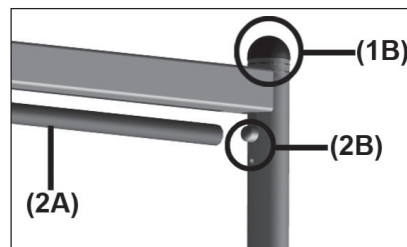
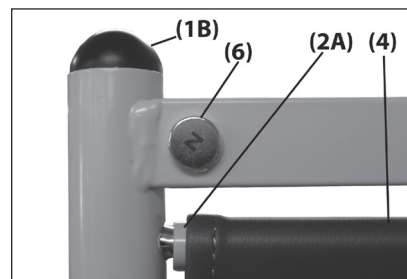
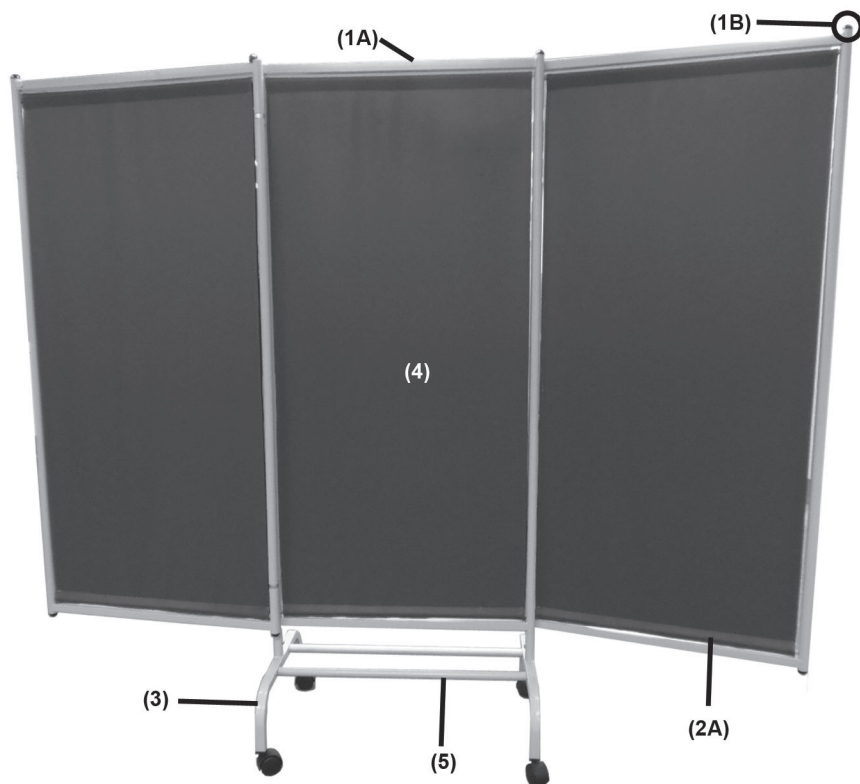

Items Included with Screen:

Item

No.	Description	Qty.
1A	Wing/Mid Frame Assembly Kit	1
1B	Domed Plastic Insert	10
2B	Snap Buttons	4
2A	Screen Rod	6
2B	Snap Buttons	12
3	Leg Frame Assembly	2
3B	2" Caster	4
3C	Caster Insert	4
3D	¾" Button Socket Screw	2
4	3170 Vinyl Panel	3
5	Screen Leg Reinforcement Tube	2
5A	2" Phillips Head Screw	4
6	MAGNET, ½" X 1/8"	2

GENERAL CARE & CLEANING

- Periodically inspect tightness of all screws, bolts, nuts, or other fasteners.

Champion furnishings are built to provide durable reliable service when properly cared for. In general all of our products should be: 1) Cleaned, 2) Rinsed and 3) Allowed to air dry. It is important to note that disinfecting a product is not the same as cleaning the product. Disinfectants alone will not provide adequate cleaning, they do not have grease or oil cutting properties to remove grime or hair and skin oils. Over time, the appearance and feel and performance of your upholstery may diminish if not cleaned properly.

CLEANING

Remove grime, hair, and body oils; Your furnishings should be cleaned with mild soap & water solution and a damp cloth on a regular basis. Avoid harsh detergents that could damage the finish of your product.

NOTE: If the furnishing is disinfected with bleach, it MUST be wiped off using only clean water on a damp cloth and then be allowed to air dry. Failure to rinse with clean water can result in a build-up of residues over time that can damage your product.

For additional cleaning information please visit www.championchair.com/cleaning-instructions/

SPECIFICATIONS



3130 Three Panel Screen



3170 Privacy Screen

Privacy Screens	3130	3170
Overall Height	70" (177.8cm)	70" (177.8cm)
Overall Width (Panels open)	79" (200.7cm)	84" (213.4cm)
Single Panel Width	27" (68.6cm)	28" (71.1cm)
Weight	25 lb. (11.3kg)	45.5 lb. (20.6kg)
Overall Height	70" (177.8cm)	70" (177.8cm)
Overall Width (Panels open)	79" (200.7cm)	84" (213.4cm)
Single Panel Width	27" (68.6cm)	28" (71.1cm)
Weight	25 lb. (11.3kg)	45.5 lb. (20.6kg)

Visit our website (ChampionManufacturing.com) to view our full line of medical furnishings and stretcher-chairs.

Additional copies of this manual and other product documents are available for download via the resources section of our website.

SPECIFICATIONS SUBJECT TO CHANGE

While we endeavor to maintain consistent products, due to conditions beyond our control, specifications are subject to change without notice. We reserve the right to add or delete products at any time and without prior notice. Always provide your product's specific serial number when ordering any replacement parts. When in doubt, contact a Champion representative (352-854-2929 or 1-800-237-3377) for further information.



Information contained in this document is based on the latest product data available at the time of printing. Photography, artwork, text and specifications are subject to change. Photographs may show optional items. Champion Manufacturing Inc. reserves the right to make changes to products, materials, options, and/or specification at any time without notice or obligation. Always provide your product's specific serial number when ordering replacement parts. Contact Champion direct for additional information and the latest specifications.